

REV	DATE	ECN NO.	APPVD BY	REL BY
A	27MAR00	UM2000-0498	FVW	CH
B	11OCT00	UM2001-0106	FVW	CH
C	16JAN01	UM2001-0214		

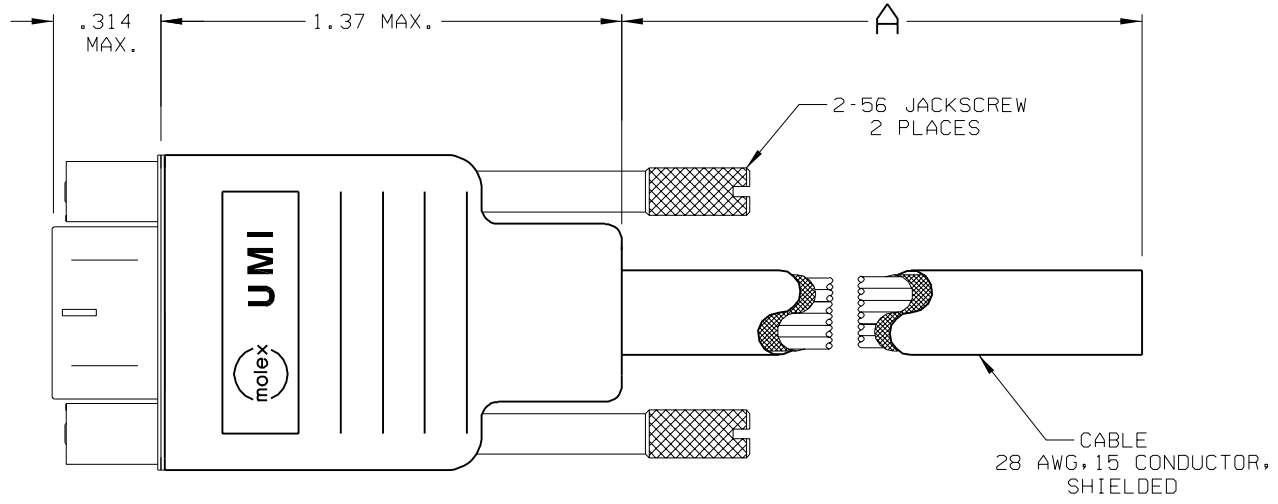
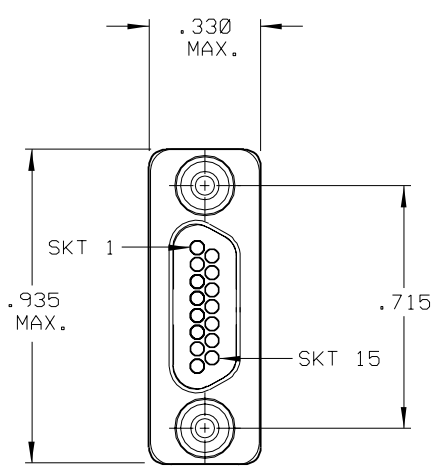

PART NUMBER	A * .5
834229016	4.5
834229007	18.5
834229013	36.5
834229017	48.5
834229018	72.5

1	BLK
2	BRN
3	RED
4	ORG
5	YEL
6	GRN
7	BLU
8	VIO
9	GRY
10	WHT
11	W/BLK
12	W/BRN
13	W/RED
14	W/ORG
15	W/YEL

SHELL

1. MARKING: NONE.

NOTES: UNLESS OTHERWISE SPECIFIED.

QUALITY SYMBOLS	UNLESS SPECIFIED: ALL DIMENSIONS IN INCHES	SCALE NONE	DWG SIZE B	THIRD ANGLE PROJECTION	REVISE ON CAD ONLY
MAJOR = 0	GENERAL TOLERANCES: 3 PLACES * .005 2 PLACES * .01 ANGULAR * 2°	DRAWN BY & DATE D.URBACH 27MAR00		TITLE: CABLE ASSEMBLY, COMMER-D, SIZE 15, RECP..18.0	
CRITICAL = 0	Umi-Mate CAGE CODE 58967	CHECKED BY & DATE F. VAN WYK		MOLEX INCORPORATED Orange, CA 92868	
SPC = 0		APPROVED BY & DATE		PART NO. SEE *TAB BLOCK*	DRAWING NO. SD-83422-9007
		THIS DRAWING CONTAINS INFORMATION THAT IS PROPRIETARY TO MOLEX INCORPORATED AND SHOULD NOT BE USED WITHOUT WRITTEN PERMISSION.			SHEET NO. 1 OF 1
				REV C	